

## CARACTERÍSTICAS DEL PRODUCTO

TRILIGHT es un sistema de fachada certificado con CLASIFICACIÓN CE.





# trilight

	PC216	ARCOPLUS 625	PC 540-3	PC 540-7	PC 560-11
<b>ANCHO</b> (mm)	200	667	500	500	500
<b>DIMENSIONES</b> (mm)	210 X 16	683 X 20	525 X 40	252 X 40	525 X 60
<b>VALOR-U</b> (W/m <sup>2</sup> K)	2,7	1,7	1,7	1,1	0,80/0,82
<b>ABSORCIÓN ACÚSTICA APROX.</b> (dB) DIN 52210	16	16	21	21	22
<b>RANGO DE COLOR</b> (STANDARD)	CRISTALL, BRONZE, OPAL		CRISTALL, OPAL		
<b>TRANSMISIÓN LUMÍNICA (%)</b>	65-35	60-35	58-30	56-30	54-28
<b>RESISTENCIA AL FUEGO</b> (EN ISO 1350-1-1)			B-S1, D0		
<b>CLASIFICACIÓN CE</b>	+	+	+	+	+

**MUROS ACRISTALADOS EN APERTURAS**  
**PANELES SIN ROTURA DEL PUEBTE TÉRMICO 40mm**

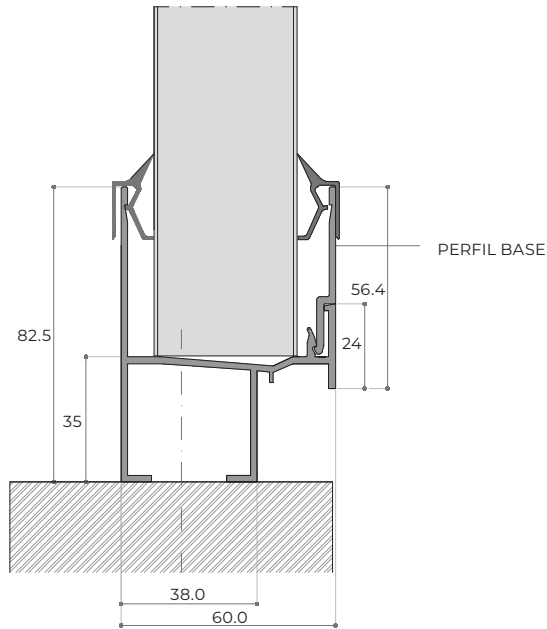
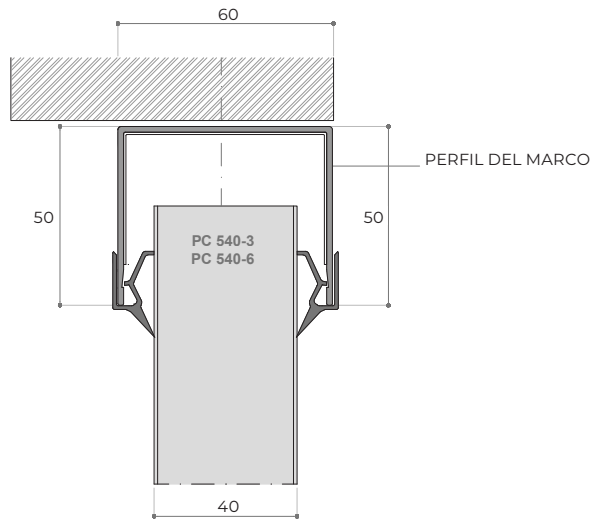

**MUROS ACRISTALADOS INSTALADOS LATERALMENTE**  
**PANELES 40mm**

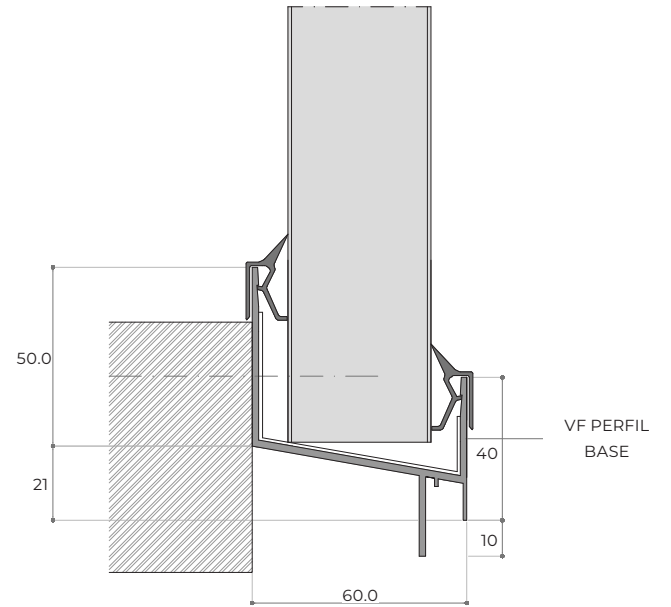
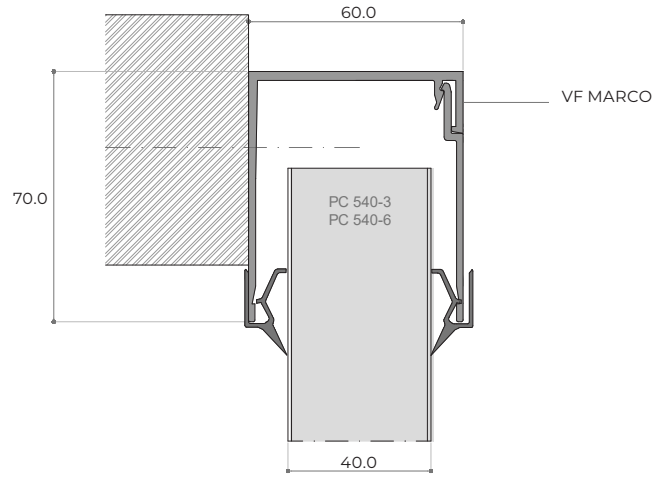

**PC 216**

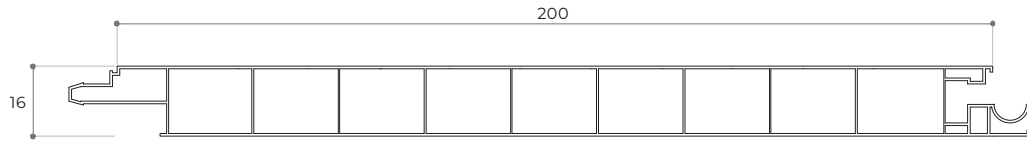

**PC 560-11**

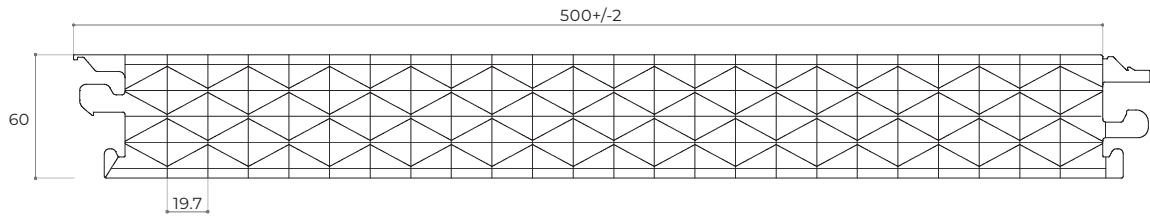

**PC 540-3**

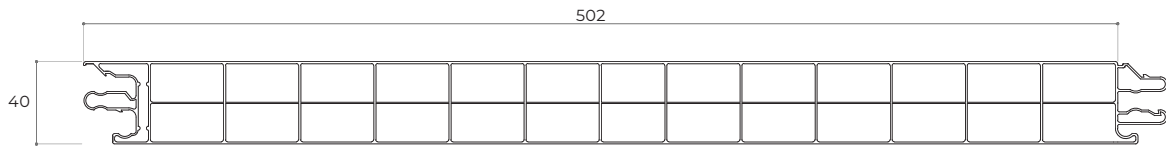

**PC 540-7**

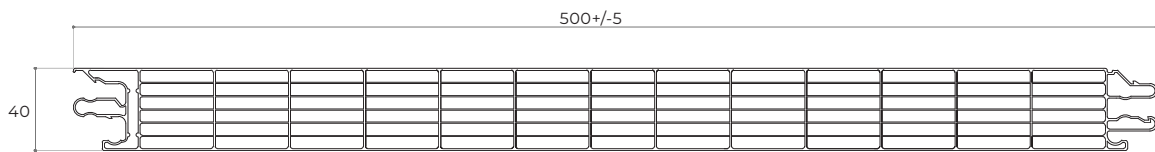

**ARCOPLUS 625**

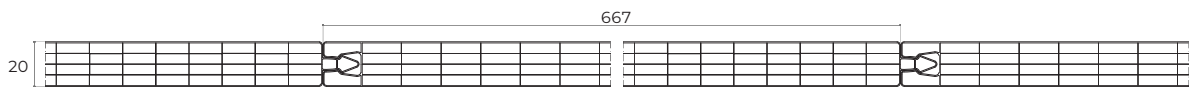



**MUROS ACRISTALADOS  
INSTALADOS LATERALMENTE**  
PANELES 60mm

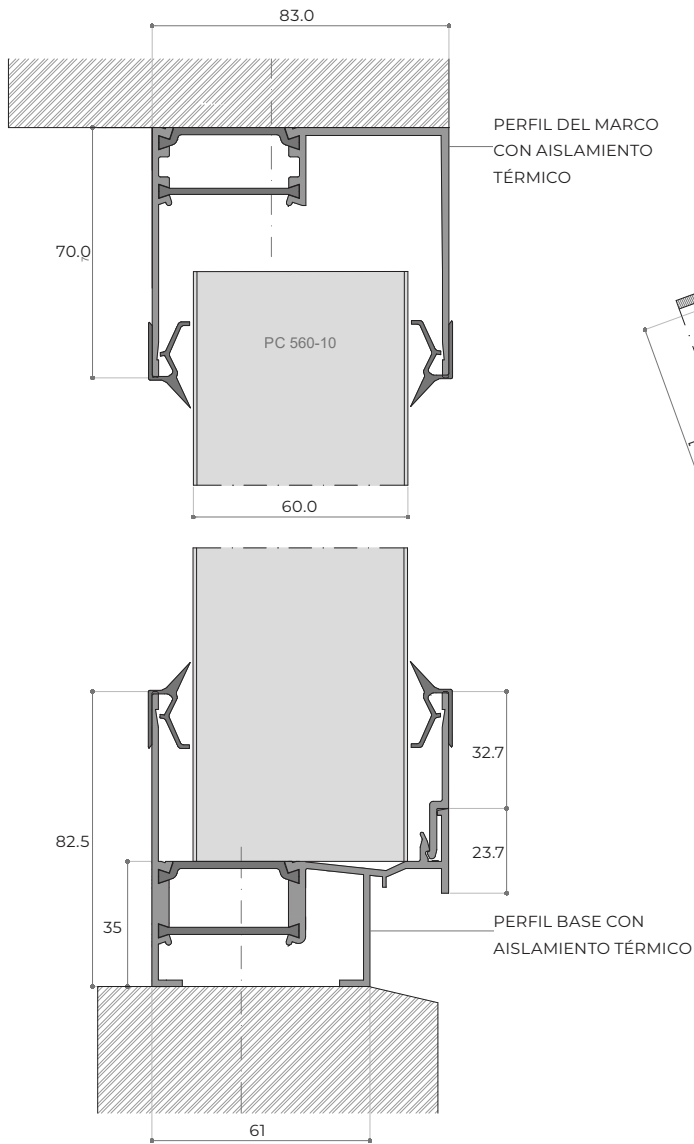

**CUBIERTA ACRISTALADA  
PENDIENTE > 25°**

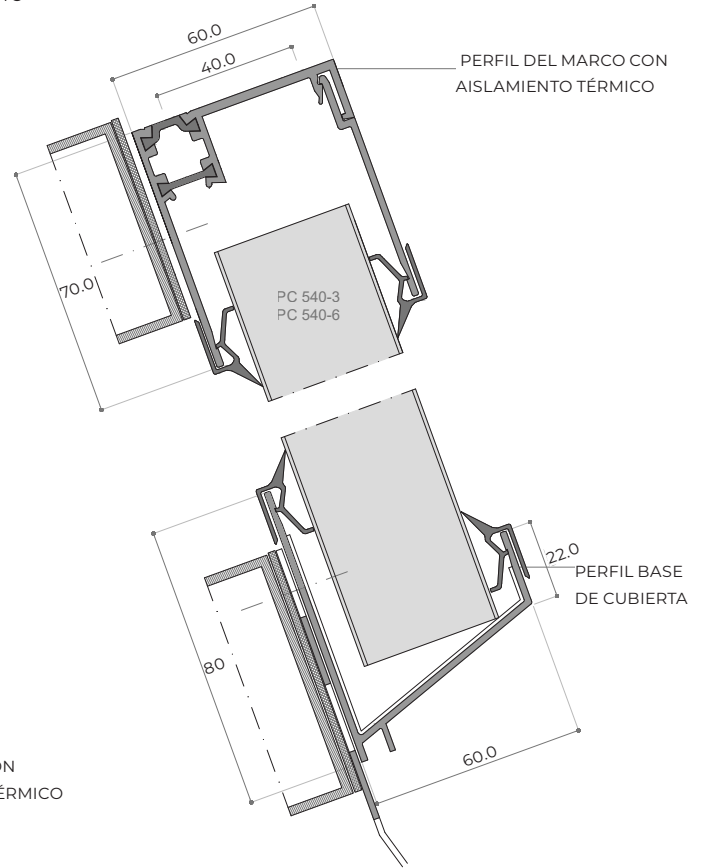

**BARRA-H DE ALUMINIO**  
PANELES 40mm

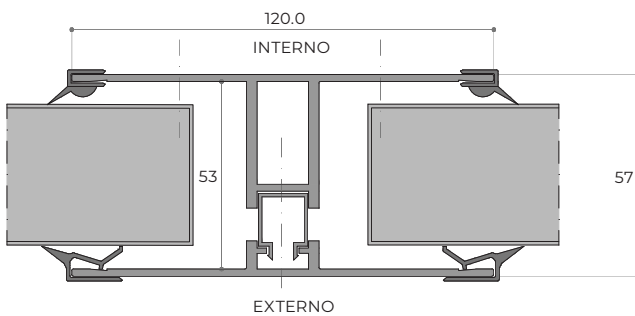

**CORREA CLIP DE ALUMINIO**

